



# Alice & Fox



---

## Dune Wardrobe

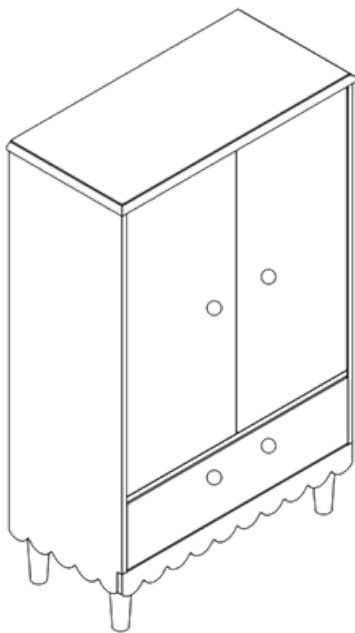

---

**IMPORTANT! READ CAREFULLY AND KEEP FOR FUTURE REFERENCE.**

Model: Alice & Fox Dune Wardrobe (SHIDA25010)

EN71-1:2014+A1:2018 & EN71-3:2019+A1:2021



# WARNINGS

**IMPORTANT! READ CAREFULLY AND KEEP FOR FUTURE REFERENCE.**

**WARNING** Do not place the product near a window as it can be used as a step and can cause a child to fall out of the window.

**WARNING** Do not place this product near a window where cords from blinds or curtains could strangle a child.

**WARNING** Do not allow children to climb on the product.

**WARNING** To prevent tipping, the product must be fixed to the wall.

**WARNING** Take care to avoid fingers being trapped when opening and closing the doors.

**WARNING** Do not use the drawer as a step.

- Adult assembly required.
- Be aware of the risk of open fires and other sources of strong heat in the vicinity of the product.
- All assembly fittings should be checked regularly and retightened as necessary.
- DO NOT use the product if any part is broken, damaged, or missing. Contact Jollyroom AB for inquiries about spare parts and instructions if needed. DO NOT replace parts with anything other than those recommended by the manufacturer.
- Max load weight: 5 kg for top bar, 20kg for shelf and 5-10 kg for drawer.
- Recommended age: 7-12 years.
- Cleaning instructions: Clean by wetting towel with water and wring it out.

PARTS

**Note!** Do not use an electric screw driver.

Ax1

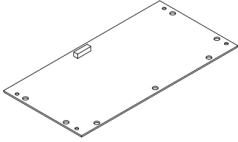

Bx1

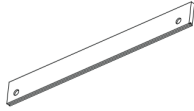

Cx1

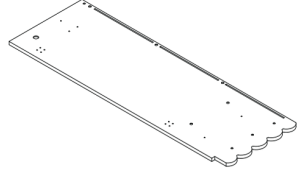

Dx1

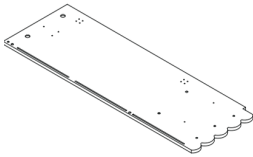

Ex1

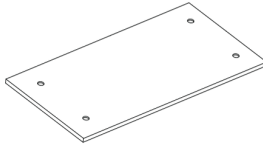

Fx2

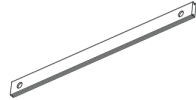

Gx3

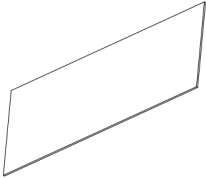

Hx1

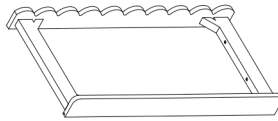

Ix4



Jx2

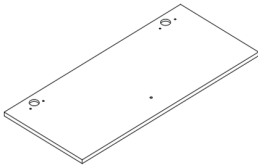

Kx1

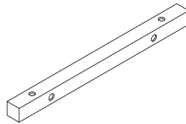

Lx1

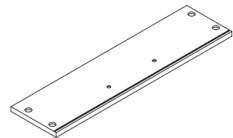

Mx1

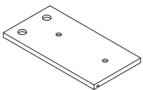

Nx1

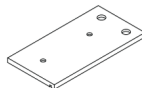

Ox1

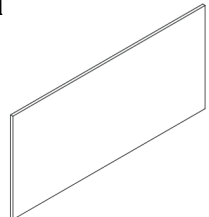

P x1

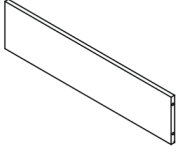

Q x1



R x1

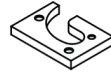

S x1

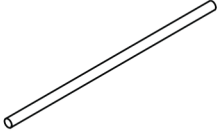

T x4



U x2



x18



x18



x8



x31



x7



x7



x7



x5



x9



x5

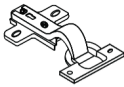

x4

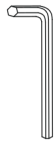

x1

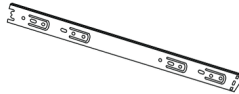

x2

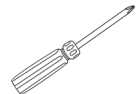
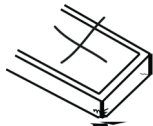



## Fall-off/Tilting Prevention Devices



1 x



1 x

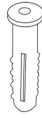

1 x

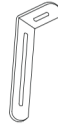

1 x



2 x

**WARNING** To prevent this furniture from tipping over, it must be permanently fixed to the wall.

The package includes fastening devices suitable for concrete or solid brick walls only. If your wall is made of a different material, or if you are unsure about the wall construction, consult a qualified professional before installation.

# Adjusting the Door Hinges

It may be necessary to adjust the hinges so that the doors align correctly. Follow the steps below as a guide.

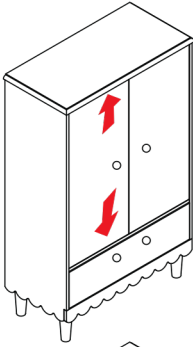

## Vertical Adjustment (Up / Down)

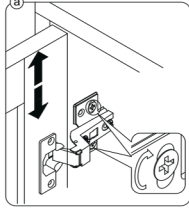

- Slightly loosen the screw as shown.
- Move the door up or down until it is aligned.
- Tighten the screw once the correct position is reached.

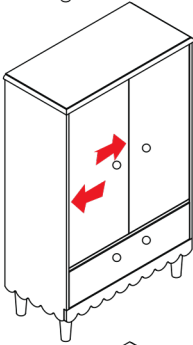

## Gap Between Door and Frame

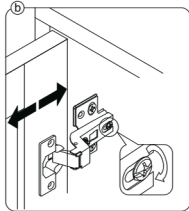

- Turn the adjustment screw to reduce or increase the gap between the door and the cabinet frame.
- Adjust until the door sits evenly against the frame.

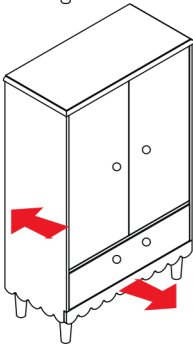

## Side-to-Side Adjustment (Left / Right)

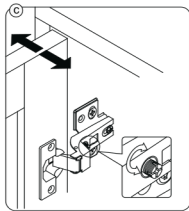

- Turn the adjustment screw clockwise or counterclockwise as shown.
- Move the door left or right until it is properly aligned.

## Final Check

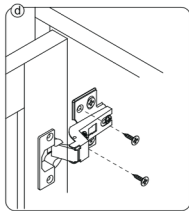

- Once the door is correctly aligned, tighten all remaining screws securely.

## VARNINGAR

### VIKTIGT! LÄS NOGA OCH SPARA FÖR FRAMTIDA BRUK.

**VARNING** Placera inte produkten nära ett fönster eftersom den kan användas som en trappsteg och orsaka att ett barn faller ut genom fönstret.

**VARNING** Placera inte produkten nära ett fönster där gardin- eller persiennsnören kan strypa ett barn.

**VARNING** Låt inte barn klättra på produkten.

**VARNING** För att förhindra att produkten tippas måste den fästas i väggen.

**VARNING** Risk för klämskador på fingrar vid öppning och stängning av dörrarna.

**VARNING** Använd inte lådan som fotsteg.

- Montering av vuxen krävs.
- Var uppmärksam på risken för öppen eld och andra starka värmekällor i närheten av produkten.
- Alla monteringsbeslag bör kontrolleras regelbundet och dras åt vid behov.
- Använd INTE produkten om någon del är trasig, skadad eller saknas. Kontakta Jollyroom AB för förfrågningar om reservdelar och instruktioner vid behov. Byt INTE ut delar mot något annat än de som rekommenderas av tillverkaren.
- Maximal belastning: 5 kg på klädstången, 20 kg på hyllplanet och 5–10 kg i lådan.
- Rekommenderad ålder: 7-12 år.
- Rengöringsanvisningar: Rengör med en fuktig trasa som har vridits ur.

# DELAR

**Obs!** Använd inte en elektrisk skruvdragare.

A x1

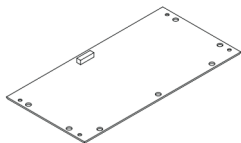

B x1

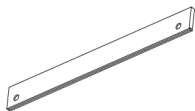

C x1

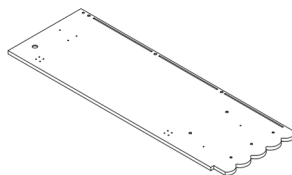

D x1

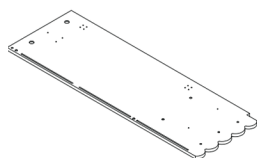

E x1

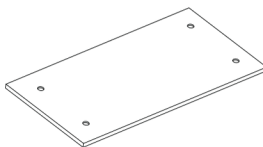

F x2

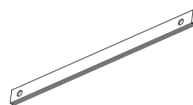

G x3

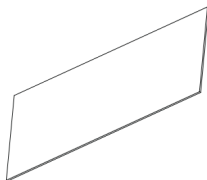

H x1

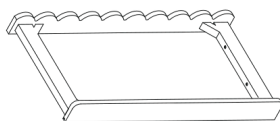

I x4



J x2

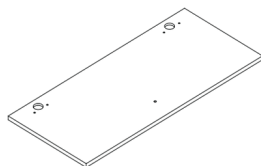

K x1

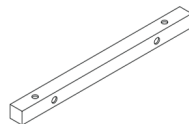

L x1

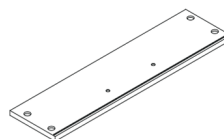

M x1

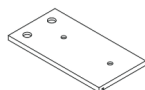

N x1

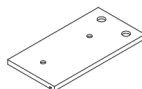

O x1

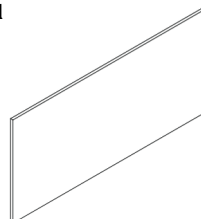

P x1

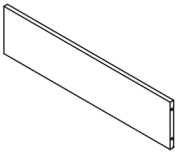

Q x1



R x1

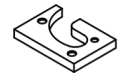

S x1

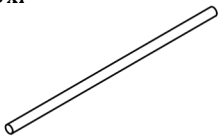

T x4



U x2



x18



x18



x8



x31



x7



x7



x7



x5



x9



x5

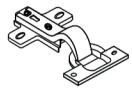

x4

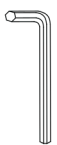

x1

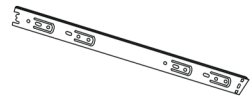

x2

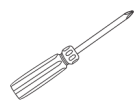
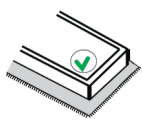
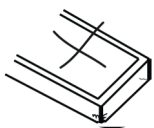

## Anordningar för att förhindra fall och tippning



1 x



1 x

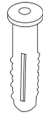

1 x

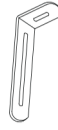

1 x



2 x

**WARNING** För att förhindra att möbelen välter måste den fästas permanent i väggen.

Förpackningen innehåller fästeanordningar som endast är lämpliga för betong- eller tegelväggar. Om din vägg är tillverkad av ett annat material, eller om du är osäker på väggens konstruktion, ska du rådfråga en kvalificerad fackman före installationen.

## Justering av Dörrens Gångjärn

Det kan vara nödvändigt att justera gångjärnen så att dörrarna linjerar korrekt. Följ stegen nedan som vägledning.

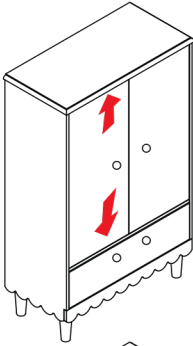

### Vertikal justering (upp/ner)

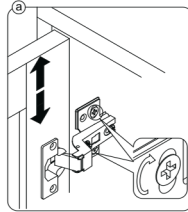

- Lossa skruven något enligt bilden.
- Flytta dörren uppåt eller nedåt tills den är i linje.
- Dra åt skruven när rätt position har uppnåtts.

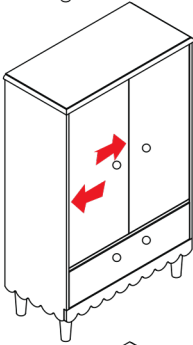

### Mellanrum mellan dörr och karm

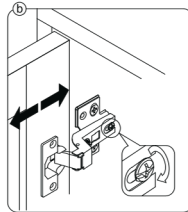

- Vrid på justeringsskruven för att minska eller öka avståndet mellan dörren och skåpstommen.
- Justera tills dörren sitter jämnt mot ramen.

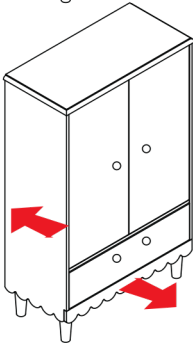

### Justering från sida till sida (vänster/höger)

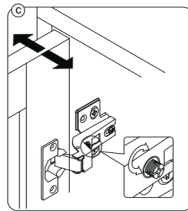

- Vrid justeringsskruven medurs eller moturs enligt bilden.
- Flytta dörren åt vänster eller höger tills den är korrekt justerad.

### Slutlig kontroll

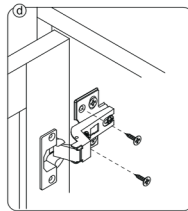

- När dörren är korrekt inriktad, dra åt alla återstående skruvar ordentligt.



## ADVARSLER

**VIKTIG! LES NØYE OG OPPBEVAR FOR FREMTIDIG REFERANSE.**

**ADVARSEL** Ikke plasser produktet i nærheten av et vindu, da det kan brukes som et trinn og føre til at et barn faller ut av vinduet.

**ADVARSEL** Ikke plasser produktet i nærheten av et vindu hvor snorer fra gardiner eller persienner kan kvele et barn.

**ADVARSEL** Ikke la barn klatre på produktet.

**ADVARSEL** For å forhindre at produktet velter, må det festes til veggen.

**ADVARSEL** Pass på at du ikke klemmer fingrene når du åpner og lukker dørene.

**ADVARSEL** Ikke bruk skuffen som trinn.

- Må monteres av en voksen.
- Vær oppmerksom på risikoen for åpen ild og andre sterke varmekilder i nærheten av produktet.
- Alle monteringsbeslag bør kontrolleres regelmessig og strammes ved behov.
- IKKE bruk produktet hvis noen del er ødelagt, skadet eller mangler. Kontakt Jollyroom AB for å få informasjon om reservedeler og instruksjoner ved behov. IKKE bytt ut deler med noe annet enn de som er anbefalt av produsenten.
- Maksimal belastning: 5 kg på klesstangen, 20 kg på hylleplanet og 5–10 kg i skuffen.
- Anbefalt alder: 7-12 år.
- Rengjøringsinstruksjoner: Rengjør med en fuktig klut som er vridd opp.

DELER

**Merk!** Ikke bruk elektrisk skrutrekker.

Ax1

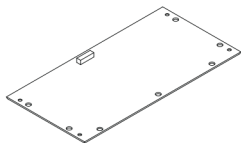

Bx1

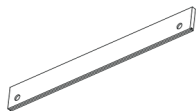

Cx1

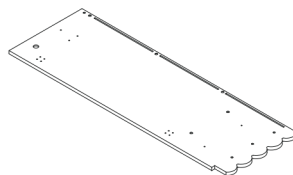

Dx1

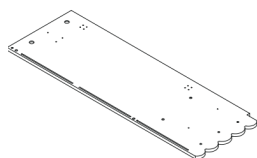

Ex1

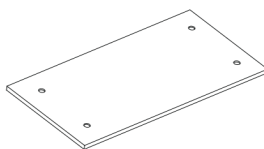

Fx2

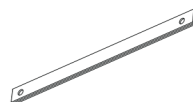

Gx3

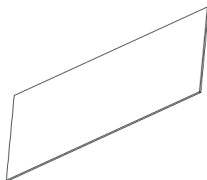

Hx1

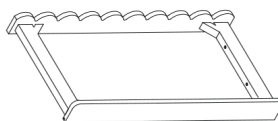

Ix4



Jx2

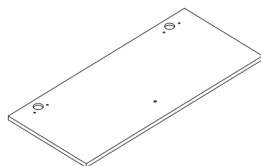

Kx1

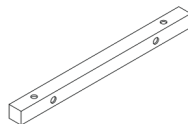

Lx1

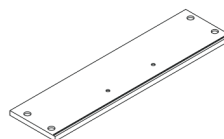

Mx1

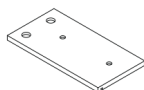

Nx1

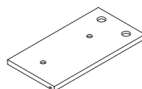

Ox1

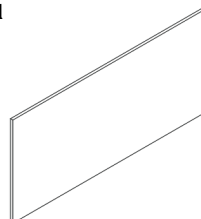

NO

P x1

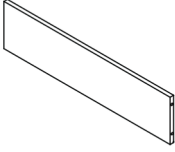

Q x1

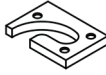

R x1

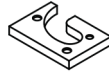

S x1

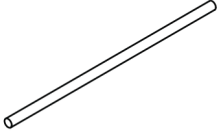

T x4



U x2



x18



x18



x8



x31



x7



x7



x7



x5



x9



x5

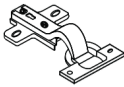

x4



x1

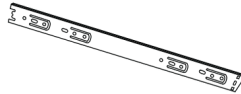

x2

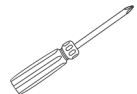
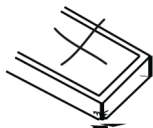



## Festeordninger for å forhindre fall og tipping



1 x



1 x

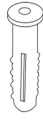

1 x

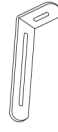

1 x



2 x

**ADVARSEL** For å forhindre at møbelet velter, må det festes permanent til vegg.

Pakken inneholder festeordninger som kun er egnet for betong- eller mursteinsvegger. Hvis veggene er laget av et annet materiale, eller du er usikker på veggkonstruksjonen, må du rådføre deg med en kvalifisert fagperson før montering.

## Justering av Dørhengslene

Det kan være nødvendig å justere hengslene slik at dørene justeres korrekt. Følg trinnene nedenfor som veiledning.

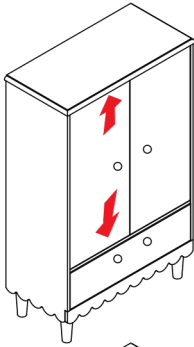

### Vertikal justering (opp/ned)

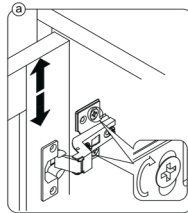

- Løsne skruen litt, som vist på bildet.
- Flytt døren opp eller ned til den er på linje med rammen.
- Stram skruen når riktig posisjon er oppnådd.

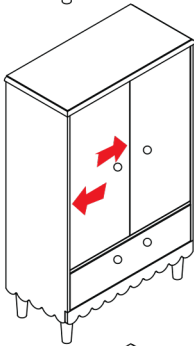

### Mellomrom mellom dør og karm

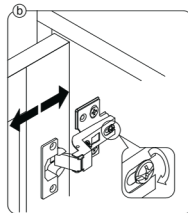

- Drei justeringsskruen for å redusere eller øke avstanden mellom døren og skaprammen.
- Juster til døren sitter jevnt mot rammen.

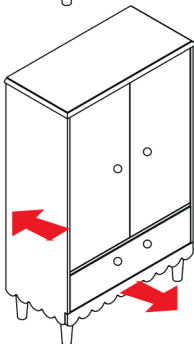

### Side-til-side-justering (venstre/høyre)

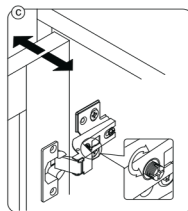

- Vri justeringsskruen med eller mot urviseren, som vist på bildet.
- Flytt døren til venstre eller høyre til den er riktig justert.

### Sluttkontroll

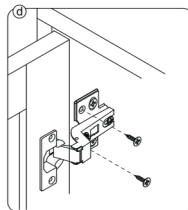

- Når døren er riktig justert, stram alle gjenværende skruer godt til.

# ADVARSLER

## VIGTIGT! LÆS OMHYGGELIGT OG GEM TIL SENERE BRUG.

**ADVARSEL** Placer ikke produktet i nærheden af et vindue, da det kan bruges som en trin og forårsage, at et barn falder ud ad vinduet.

**ADVARSEL** Placer ikke produktet i nærheden af et vindue, hvor snore fra gardiner eller persienner kan udgøre en kvælningsrisiko for et barn.

**ADVARSEL** Lad ikke børn klatre op på produktet.

**ADVARSEL** For at undgå, at produktet vælter, skal det fastgøres til væggen.

**ADVARSEL** Pas på, at du ikke får fingrene i klemme, når du åbner og lukker dørene.

**ADVARSEL** Brug ikke skuffen som trinbræt.

- Skal samles af en voksen.
- Vær opmærksom på risikoen for åben ild og andre stærke varmekilder i nærheden af produktet.
- Alle monteringsbeslag bør kontrolleres regelmæssigt og efterspændes efter behov.
- Brug IKKE produktet, hvis nogen del er ødelagt, beskadiget eller mangler. Kontakt Jollyroom AB for forespørgsler om reservedele og instruktioner, hvis det er nødvendigt. Udskift IKKE dele med andet end det, der er anbefalet af producenten.
- Maksimal belastning: 5 kg på tøjstangen, 20 kg på hyldeplanet og 5-10 kg i skuffen.
- Anbefalet alder: 7-12 år.
- Rengøringsinstruktioner: Rengør med en opvredet, fugtig klud.

DELE

**Bemærk!** Brug ikke en elektrisk skruetrækker.

A x1

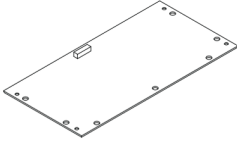

B x1

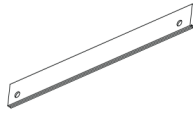

C x1

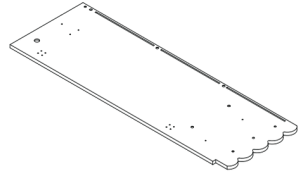

D x1

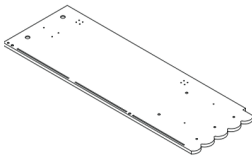

E x1

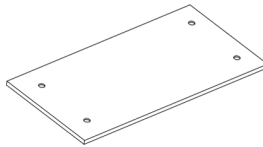

F x2

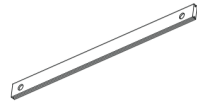

G x3

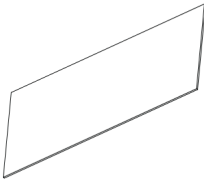

H x1

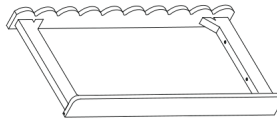

I x4



J x2

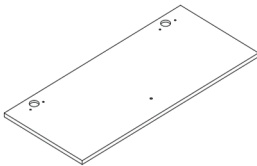

K x1

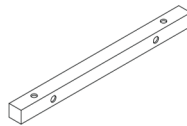

L x1

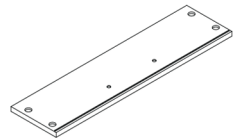

M x1

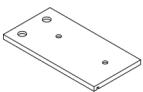

N x1

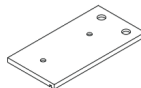

O x1

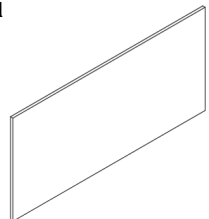

P x1

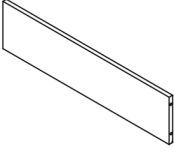

Q x1



R x1

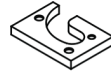

S x1

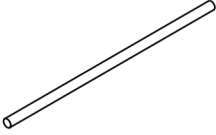

T x4



U x2



x18



x18



x8



x31



x7



x7



x7



x5



x9



x5

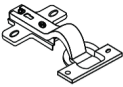

x4



x1

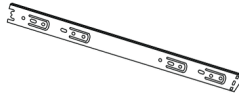

x2

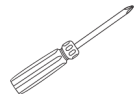
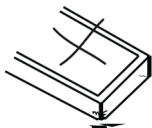

### Anordninger til forhindring af fald og væltning



1 x



1 x

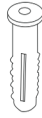

1 x

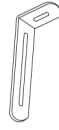

1 x



2 x

**ADVARSEL** For at undgå, at dette møbel vælter, skal det fastgøres permanent til væggen.

Pakken indeholder fastgørelsesanordninger, der kun er egnet til beton eller massive murstensvægge. Hvis din væg er lavet af et andet materiale, eller hvis du er usikker på vægkonstruktionen, skal du kontakte en kvalificeret fagmand før installation.

## Justering af Dørhængslerne

Det kan være nødvendigt at justere hængslerne, så dørene justeres korrekt. Følg trinene nedenfor som vejledning.

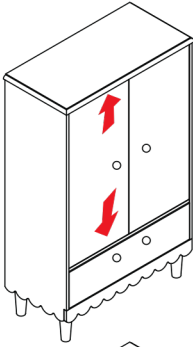

### Lodret justering (op/ned)

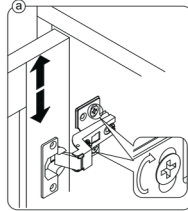

- Løsn skruen ley som vist.
- Flyt døren op eller ned, indtil den er justeret.
- Stram skruen, når den korrekte position er nået.

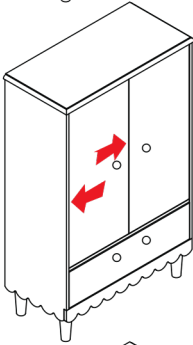

### Mellemrum mellem dør og karm

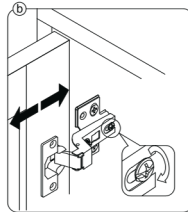

- Skru på justeringsskruen for at mindske eller øge afstanden mellem døren og skabsrammen.
- Juster, indtil døren sidder jævnt mod rammen.

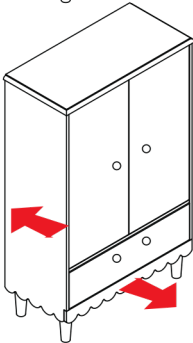

### Side-til-side-justering (venstre/højre)

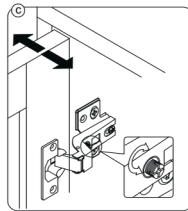

- Skru justeringsskruen med eller mod uret som vist.
- Flyt døren til venstre eller højre, indtil den er korrekt justeret.

### Afslutning

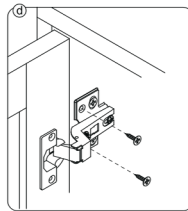

- Når døren er justeret korrekt, skal de resterende skruer spændes godt fast.

## VAROITUKSET

**TÄRKEÄÄ! LUE HUOLELLISESTI JA SÄILYÄ MYÖHEMPÄÄ KÄYTTÖÄ VARTEN.**

**VAROITUS** Älä sijoita tuotetta ikkunan lähelle, koska sitä voidaan käyttää askelmana, mikä voi johtaa lapsen putoamiseen ikkunasta.

**VAROITUS** Älä sijoita tuotetta ikkunan lähelle, jossa verhojen tai kaihtimien narut voivat aiheuttaa kuristumisvaaran lapselle.

**VAROITUS** Älä anna lasten kiivetä tuotteen päälle.

**VAROITUS** Kaatumisen estämiseksi tuote on kiinnitettävä seinään.

**VAROITUS** Varo, etteivät sormet jää väliin, kun avaat ja suljet ovet.

**VAROITUS** Älä käytä laatikkoa portaana.

- Tuote tulee koota aikuisen toimesta.
- Ole tietoinen avoimen tulen ja muiden voimakkaiden lämmönlähteiden aiheuttamasta riskistä tuotteen läheisyydessä.
- Kaikki kiinnikkeet tulisi tarkistaa säännöllisesti ja kiristää tarvittaessa.
- ÄLÄ käytä tuotetta, jos jokin osa on rikki, vaurioitunut tai puuttuu. Ota tarvittaessa yhteyttä Jollyroom AB:hen varaosia ja ohjeita koskevilla tiedusteluissa. ÄLÄ korvaa osia muilla kuin valmistajan suosittelemilla osilla.
- Suurin kuormitus: 5 kg vaatetangolla, 20 kg hyllytasolla ja 5–10 kg laatikossa.
- Suositusikä: 7–12 vuotta.
- Puhdistusohjeet: Puhdista kostealla, hyvin väännetyllä liinalla.

OSAT

**Huom!** Älä käytä sähköruuvimeisseliä.

A x1

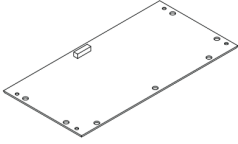

B x1

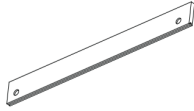

C x1

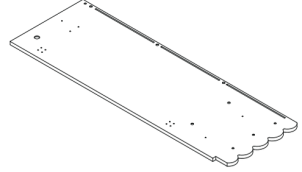

D x1

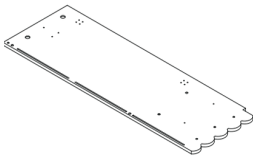

E x1

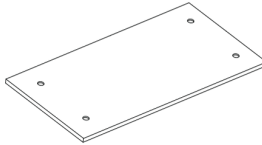

F x2

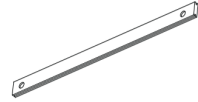

G x3

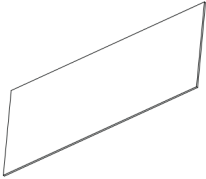

H x1

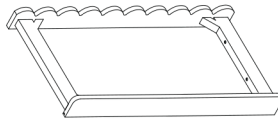

I x4



J x2

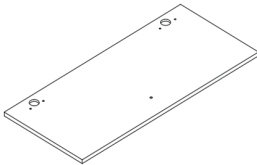

K x1

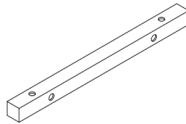

L x1

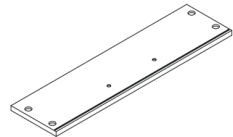

M x1

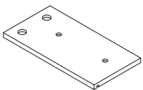

N x1

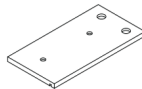

O x1

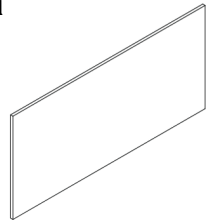

P x1

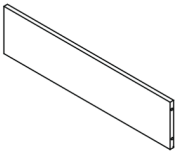

Q x1

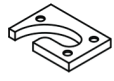

R x1

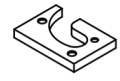

S x1

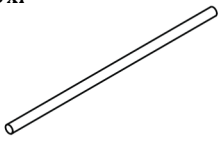

T x4



U x2



x18



x18



x8

Ø8\*30mm



x31

Ø5\*12mm



x7

Ø4\*20mm



x7

Ø4\*25mm



x7

Ø4\*30mm

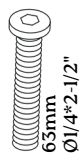

x5

63mm  
Ø1/4\*2-1/2"

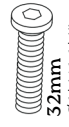

x9

32mm  
Ø1/4\*1-1/4"



x5

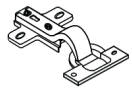

x4

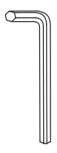

x1

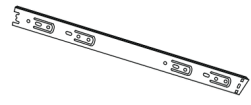

x2

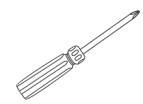
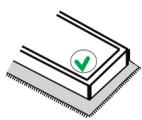
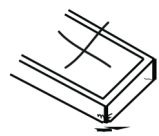

## Kaatumisen/kallistumisen estolaitteet



1 x

Ø4\*35mm



1 x

Ø3\*16mm

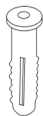

1 x

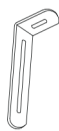

1 x



2 x

**VAROITUS** Kaatumisen estämiseksi kaluste on kiinnitettävä pysyvästi seinään.

Pakkaus sisältää kiinnitystarvikkeet, jotka soveltuvat ainoastaan betoni- tai täystiiliseinille. Jos seinäsi on valmistettu muusta materiaalista tai et ole varma seinärakenteesta, ota yhteyttä pätevään ammattilaiseen ennen asennusta.

## Oven saranoiden säätäminen

Saattaa olla tarpeen säätää saranointia, jotta ovet kohdistuvat oikein. Noudata alla olevia ohjeita opastuksena.

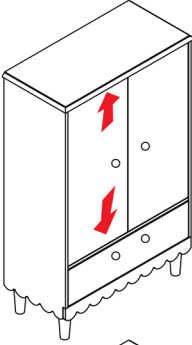

### Pystysäätö (ylös/alas)

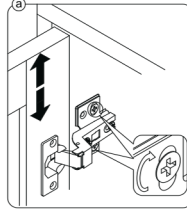

- Löysää ruuvia kuvan mukaisesti.
- Siirrä ovea ylös tai alas, kunnes se asettuu paikalleen.
- Kiristä ruuvi, kun oikea asento on saavutettu.

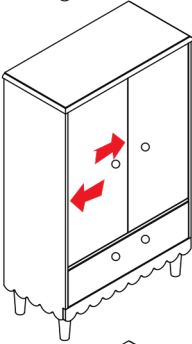

### Oven ja karmin välinen rako

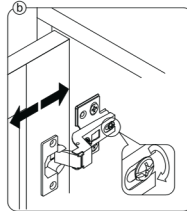

- Käännä säätöruuvia oven ja kaapin rungon välisen raon pienentämiseksi tai suurentämiseksi.
- Säädä, kunnes ovi istuu tasaisesti kehystä vasten.

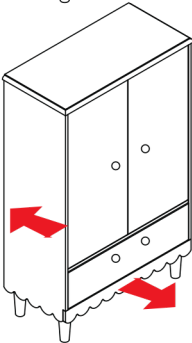

### Sivuttaissäätö (vasen/oikea)

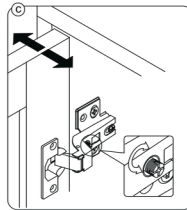

- Käännä säätöruuvia myötä- tai vastapäivään kuvan mukaisesti.
- Siirrä ovea vasemmalle tai oikealle, kunnes se asettuu paikalleen.

### Lopputarkastus

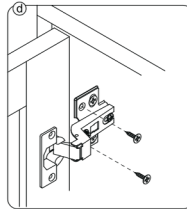

- Kun ovi on kohdistettu oikein, kiristä kaikki jäljellä olevat ruuvit tiukasti.

# WARNUNGEN

## WICHTIG! SORGFÄLTIG LESEN UND FÜR SPÄTERE VERWENDUNG AUFBEWAHREN.

**WARNUNG** Stellen Sie das Produkt nicht in Fensternähe auf, da es als Tritt verwendet werden kann und ein Kind aus dem Fenster fallen könnte.

**WARNUNG** Stellen Sie das Produkt nicht in die Nähe eines Fensters, wo Schnüre von Jalousien oder Vorhängen ein Kind strangulieren könnten.

**WARNUNG** Achten Sie darauf, dass Sie sich beim Öffnen und Schließen der Türen nicht die Finger einklemmen.

**WARNUNG** Verwenden Sie die Schublade nicht als Trittstufe.

**WARNUNG** Erlauben Sie Kindern nicht, auf das Produkt zu klettern.

**WARNUNG** Um ein Umkippen zu verhindern, muss das Produkt an der Wand befestigt werden.

- Die Montage muss durch einen Erwachsenen erfolgen.
- Achten Sie auf die Gefahr offener Flammen und anderer starker Wärmequellen in der Nähe des Produkts.
- Alle Montageteile sollten regelmäßig überprüft und bei Bedarf nachgezogen werden
- Benutzen Sie das Produkt NICHT, wenn ein Teil gebrochen oder beschädigt ist oder fehlt. Wenden Sie sich bei Bedarf an Jollyroom AB, um Ersatzteile und Anleitungen anzufordern. Ersetzen Sie KEINE Teile mit etwas anderem als den vom Hersteller empfohlenen Teilen.
- Maximale Belastung: 5 kg an der Kleiderstange, 20 kg am Regalboden und 5–10 kg in der Schublade.
- Empfohlenes Alter: 7-12 Jahren.
- Reinigungshinweise: Mit einem feuchten, gut ausgewrungenen Tuch reinigen.

TEILE

**Hinweis!** Verwenden Sie keinen elektrischen Schraubendreher.

A x1

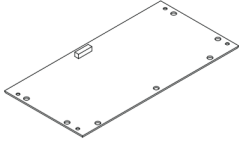

B x1

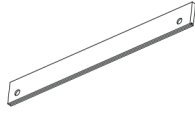

C x1

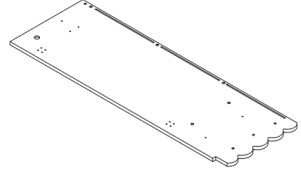

D x1

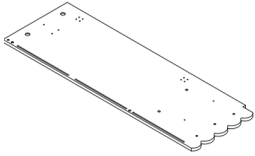

E x1

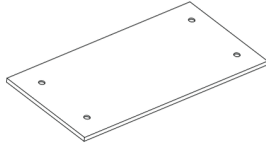

F x2

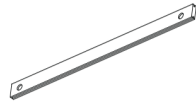

G x3

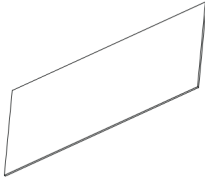

H x1

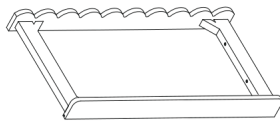

I x4



J x2

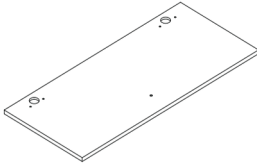

K x1

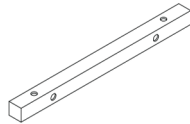

L x1

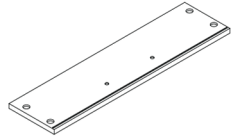

M x1

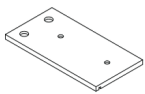

N x1

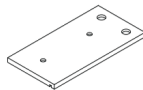

O x1

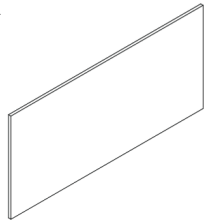

P x1

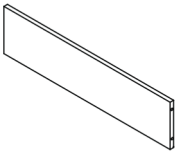

Q x1

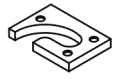

R x1

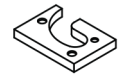

S x1

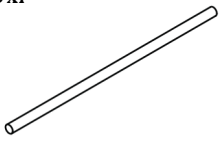

T x4



U x2



x18



x18



x8

Ø8\*30mm



x31

Ø5\*12mm



x7

Ø4\*20mm



x7

Ø4\*25mm



x7

Ø4\*30mm

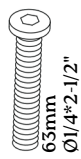

x5

63mm  
Ø1/4\*2-1/2"

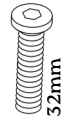

x9

32mm  
Ø1/4\*1-1/4"



x5

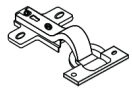

x4

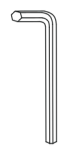

x1

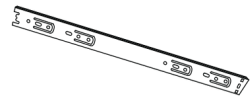

x2

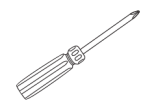
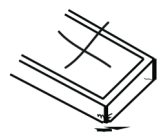

### Vorrichtungen zur Verhinderung des Herunterfallens/Kippens



1 x



1 x

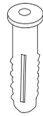

1 x

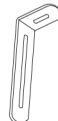

1 x



2 x

**WARNUNG** Um ein Umkippen dieses Möbels zu verhindern, muss es dauerhaft an der Wand befestigt werden.

Im Lieferumfang sind Befestigungsvorrichtungen enthalten, die nur für Beton- oder Vollziegelwände geeignet sind. Wenn Ihre Wand aus einem anderen Material besteht oder wenn Sie sich über die Wandkonstruktion unsicher sind, wenden Sie sich vor der Installation an einen qualifizierten Fachmann.

## Einstellen der Türscharniere

Es kann erforderlich sein, die Scharniere einzustellen, damit die Türen korrekt ausgerichtet sind. Befolgen Sie die nachstehenden Schritte als Anleitung.

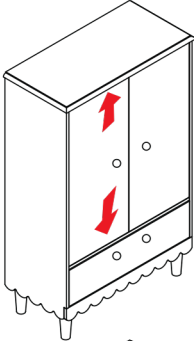

### Vertikale Einstellung (nach oben/unten)

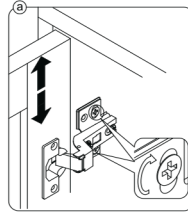

- Lösen Sie die Schraube wie gezeigt leicht.
- Bewegen Sie die Tür nach oben oder unten, bis sie ausgerichtet ist.
- Ziehen Sie die Schraube an, sobald die richtige Position erreicht ist.

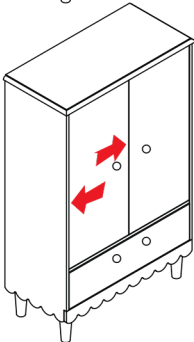

### Spalt zwischen Tür und Rahmen

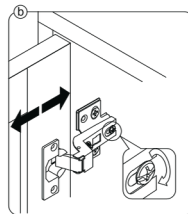

- Drehen Sie die Einstellschraube, um den Abstand zwischen der Tür und dem Schrankrahmen zu verringern oder zu vergrößern.
- Justieren Sie, bis die Tür gleichmäßig am Rahmen anliegt.

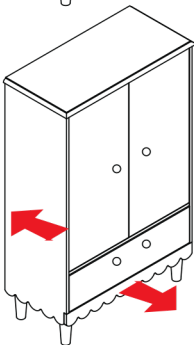

### Seitenverschiebung (links/rechts)

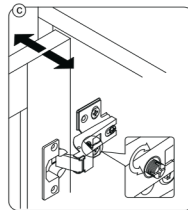

- Drehen Sie die Einstellschraube wie abgebildet im oder gegen den Uhrzeigersinn.
- Bewegen Sie die Tür nach links oder rechts, bis sie richtig ausgerichtet ist.

### Endkontrolle

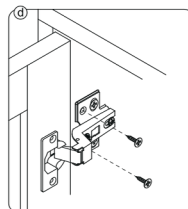

- Sobald die Tür korrekt ausgerichtet ist, ziehen Sie alle übrigen Schrauben fest an.

# ASSEMBLY INSTRUCTIONS

MONTERING/ASENNUS/MONTAGE

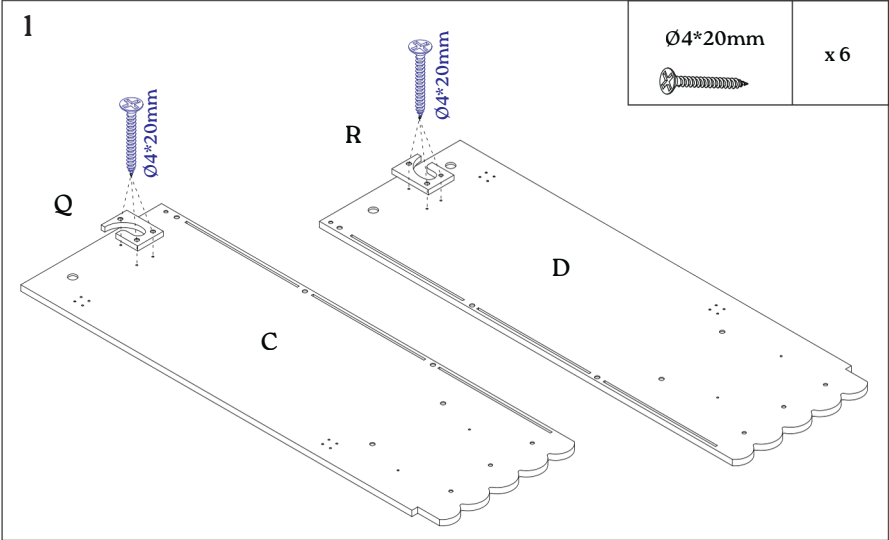

2

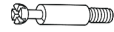
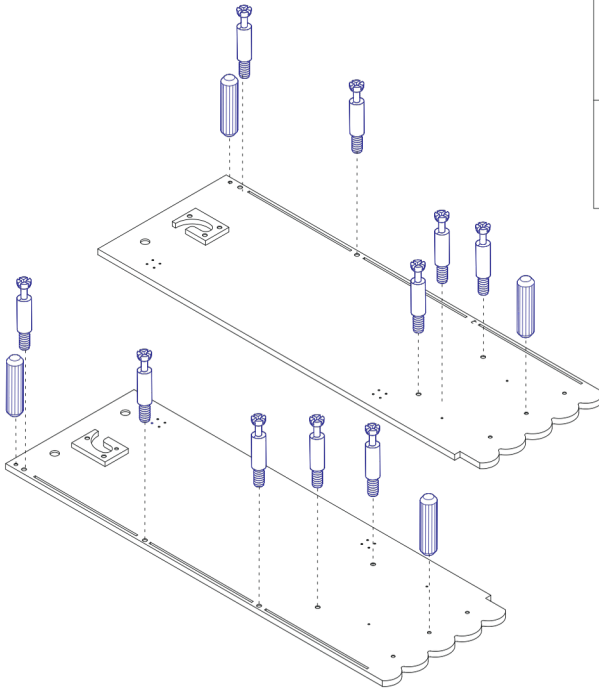

10



4

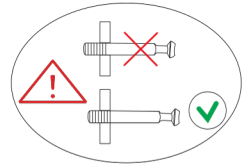

3

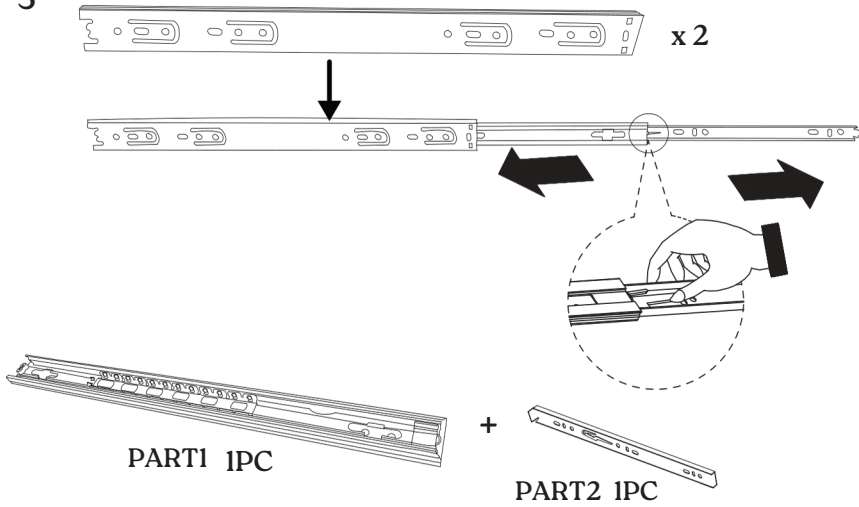

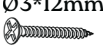

4

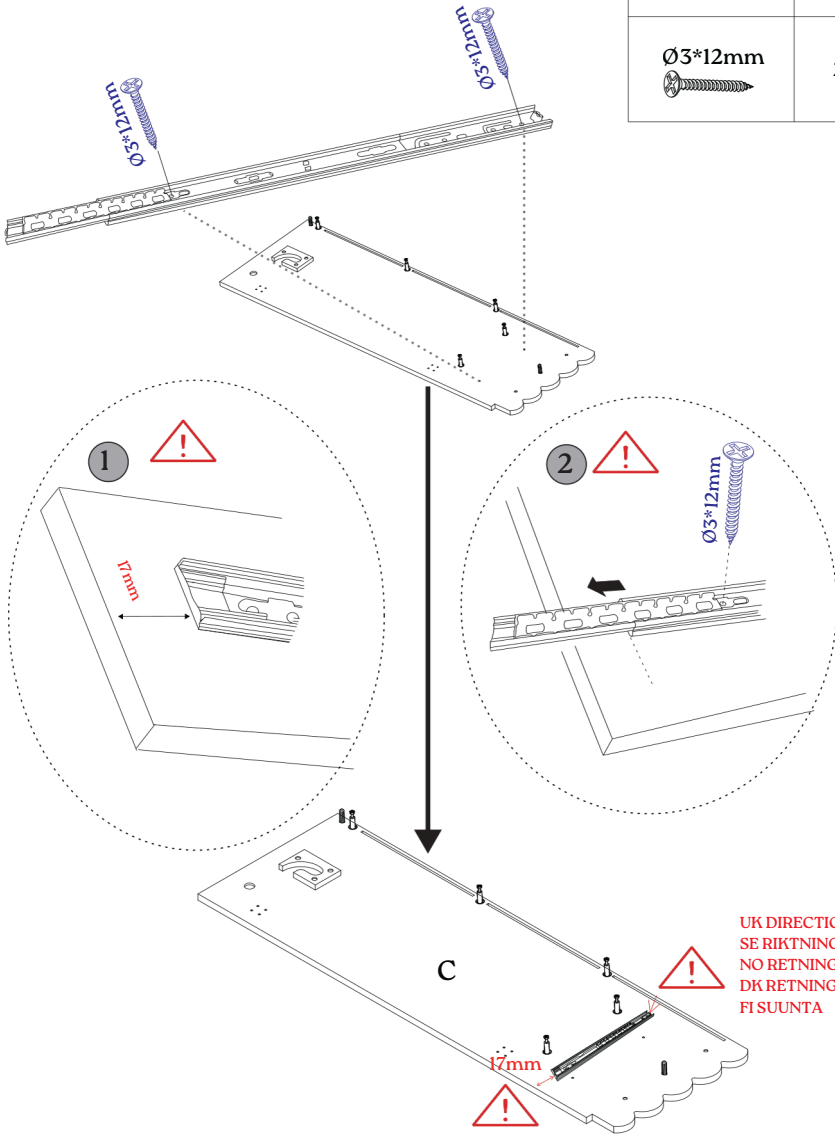
 <p>PART1</p>	1
 <p>Ø3*12mm</p>	2



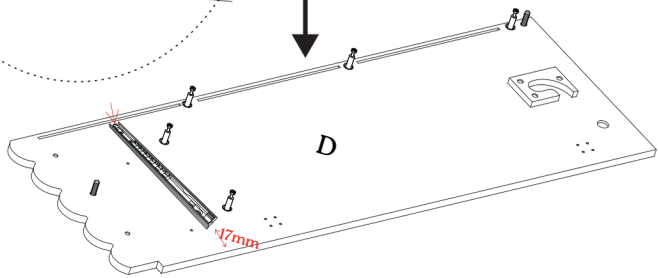
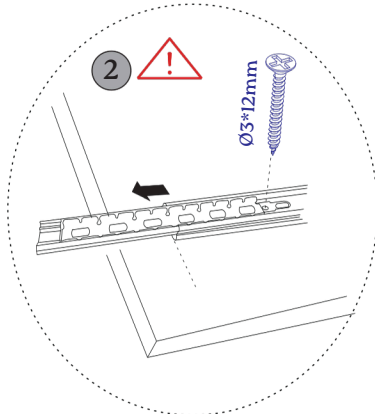
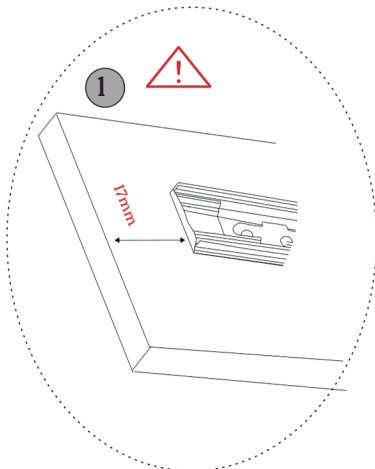
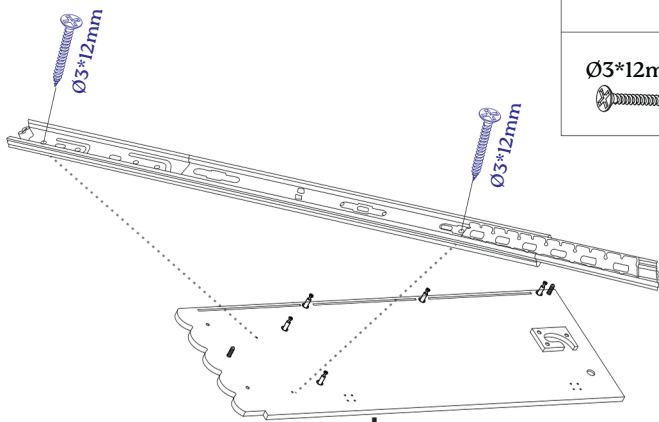

5

<p>PART1</p> 	<p>1</p>
<p>Ø3*12mm</p> 	<p>2</p>

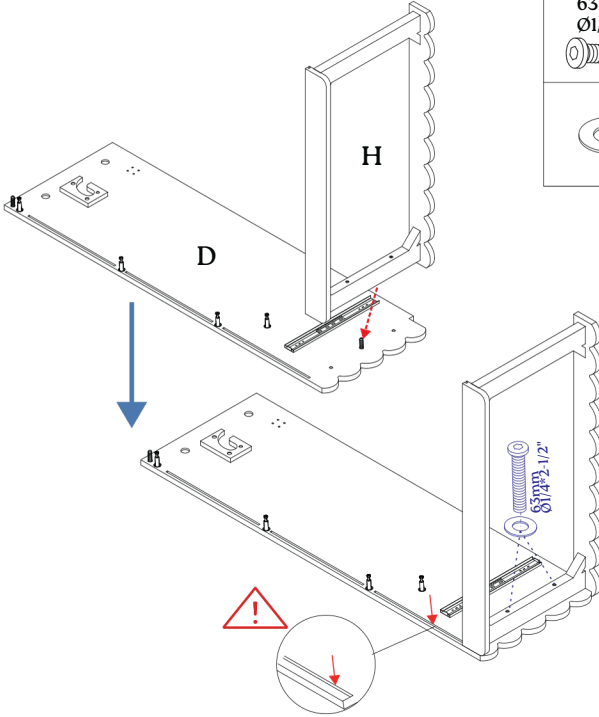

6



63mm Ø1/4"2-1/2"	2
	2

7

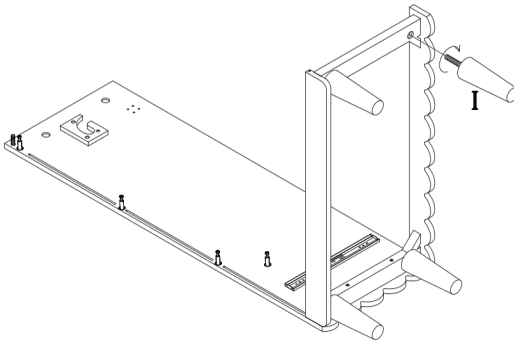

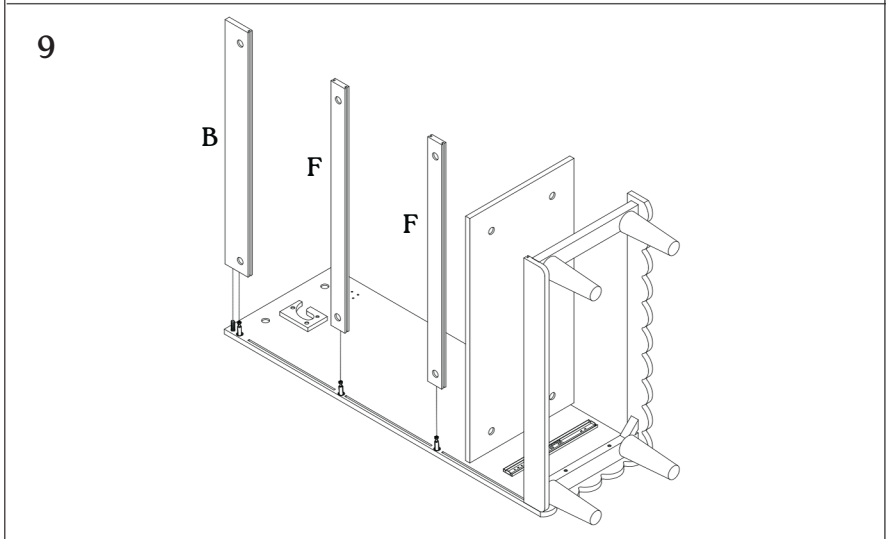
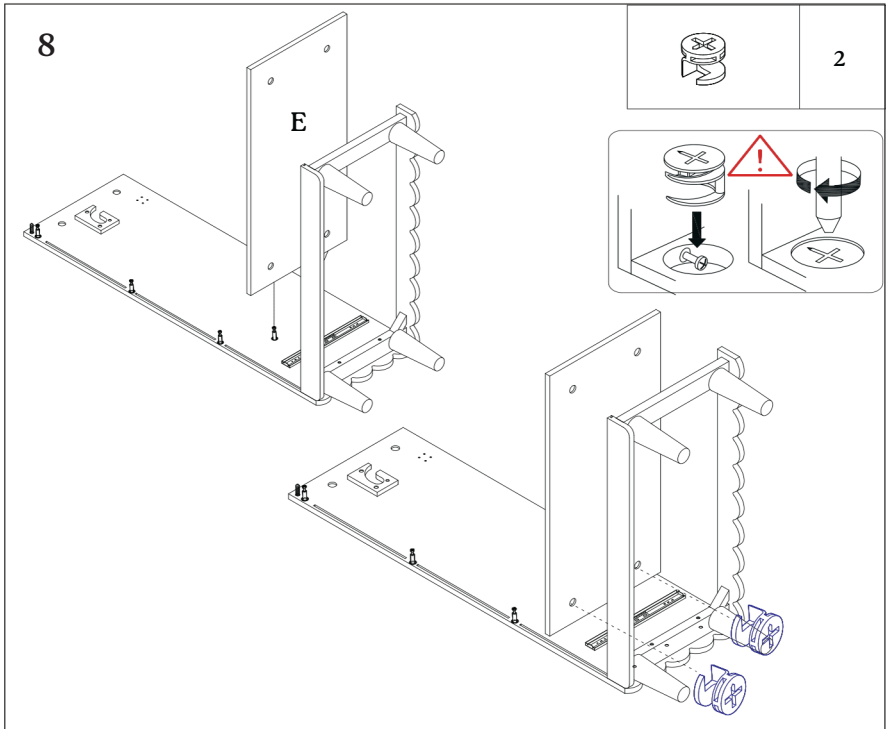

10

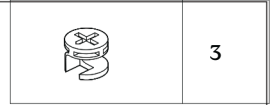
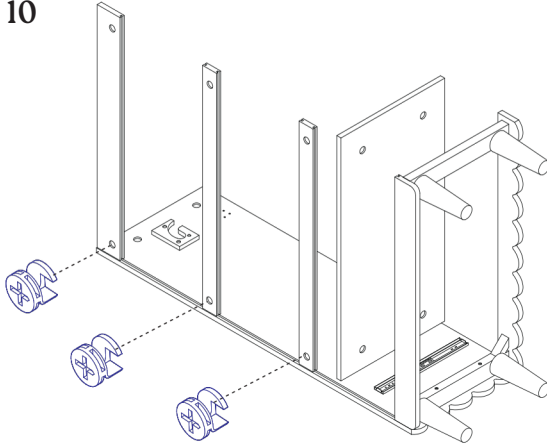

3

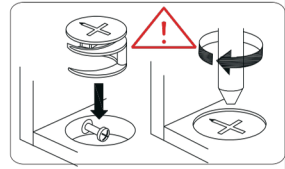

11

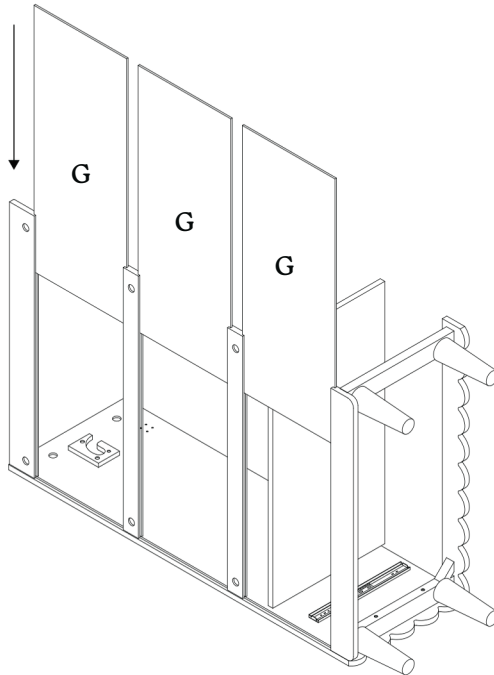

13

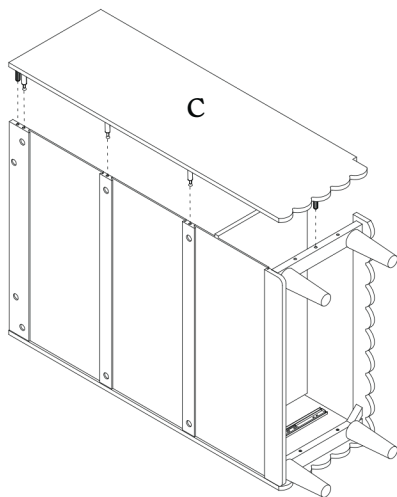

14

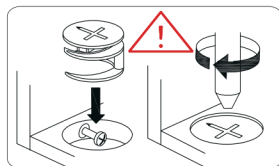
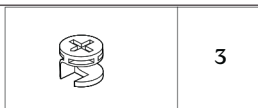
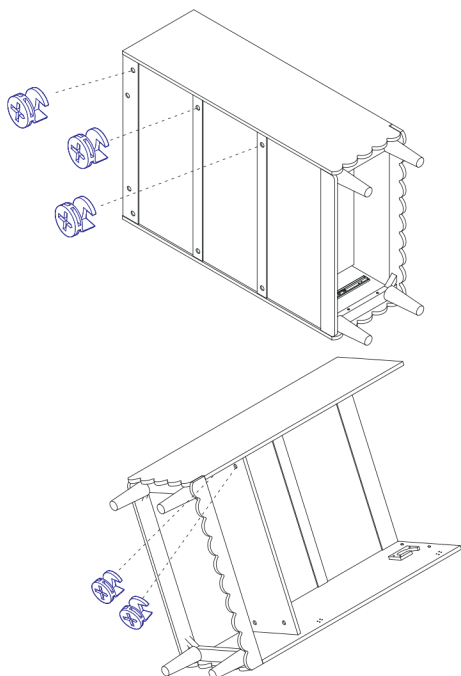



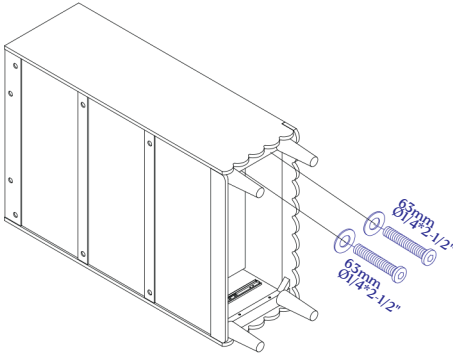

15

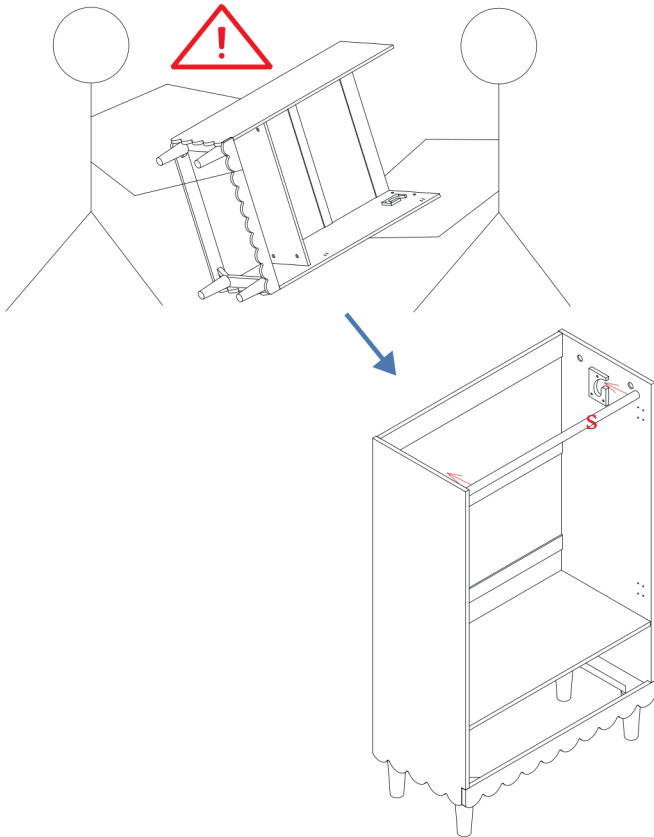

63mm Ø1/4\"2-1/2"	2
	2

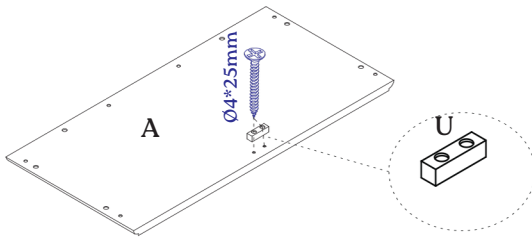
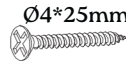
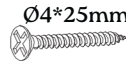
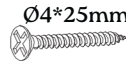
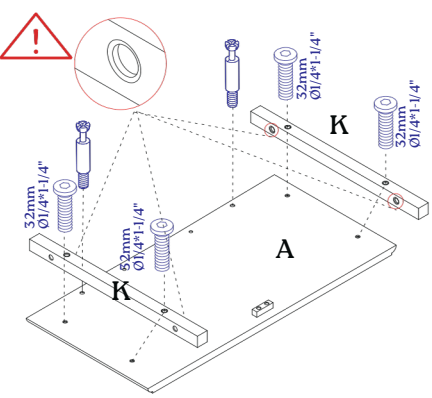
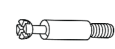
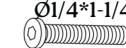
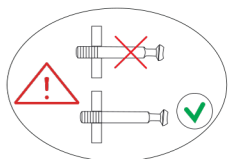
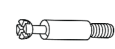
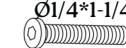
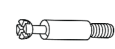
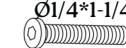
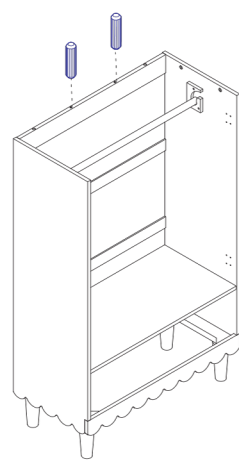
16



<p>17</p> 	<table border="1"> <tr> <td data-bbox="748 122 920 231"> <p>Ø4*25mm</p>  </td> <td data-bbox="920 122 1006 231"> <p>2</p> </td> </tr> </table>	<p>Ø4*25mm</p> 	<p>2</p>		
<p>Ø4*25mm</p> 	<p>2</p>				
<p>18</p> 	<table border="1"> <tr> <td data-bbox="748 443 909 550">  </td> <td data-bbox="909 443 1006 550"> <p>2</p> </td> </tr> <tr> <td data-bbox="748 550 909 657"> <p>32mm Ø1/4*1-1/4"</p>  </td> <td data-bbox="909 550 1006 657"> <p>4</p> </td> </tr> </table> 		<p>2</p>	<p>32mm Ø1/4*1-1/4"</p> 	<p>4</p>
	<p>2</p>				
<p>32mm Ø1/4*1-1/4"</p> 	<p>4</p>				
<p>19</p> 	<table border="1"> <tr> <td data-bbox="748 901 920 1008"> <p>Ø8*30mm</p>  </td> <td data-bbox="920 901 1006 1008"> <p>2</p> </td> </tr> </table>	<p>Ø8*30mm</p> 	<p>2</p>		
<p>Ø8*30mm</p> 	<p>2</p>				

20

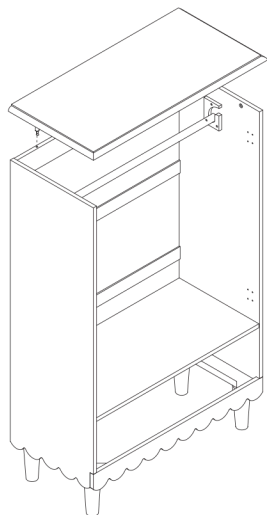

21

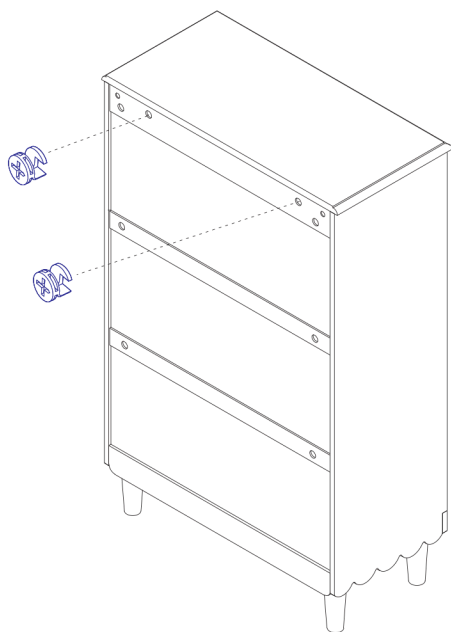

22



2

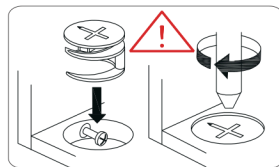

22

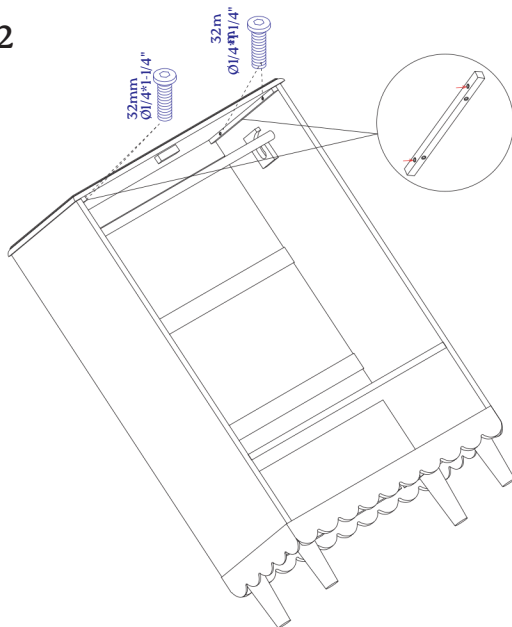

32mm  
Ø1/4\*1-1/4"

4

23

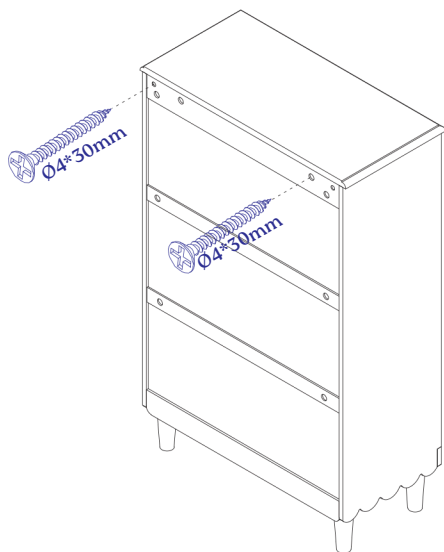

Ø4\*30mm

2

24

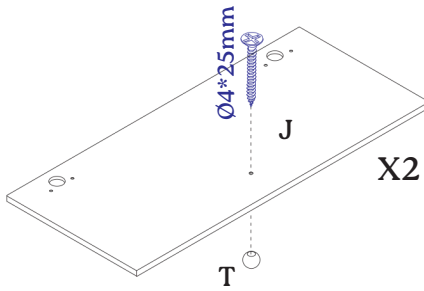

$\text{Ø}4*25\text{mm}$



2

25

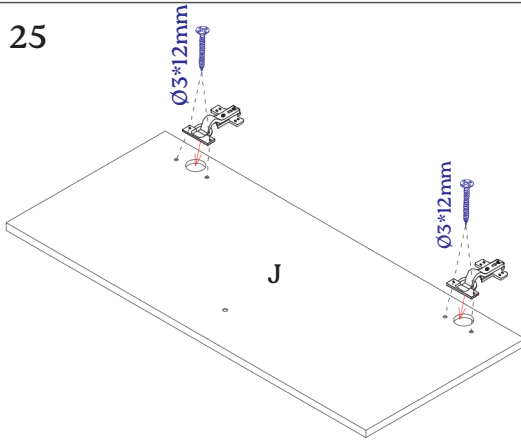

$\text{Ø}3*12\text{mm}$



8



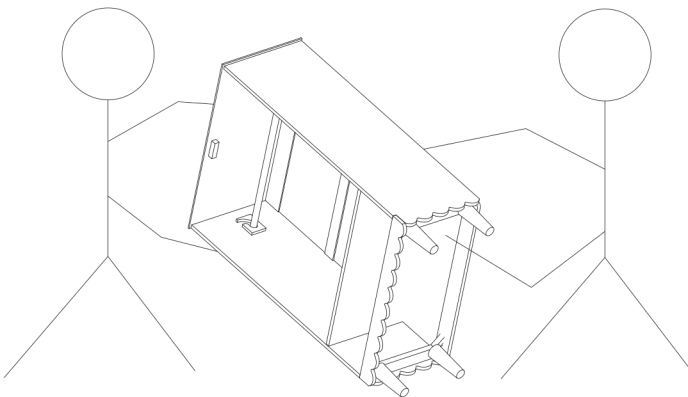

4

26



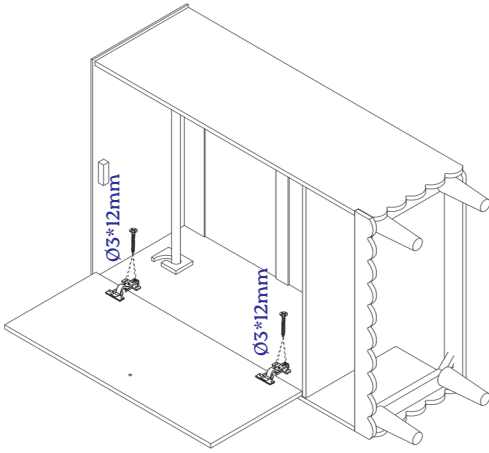

27

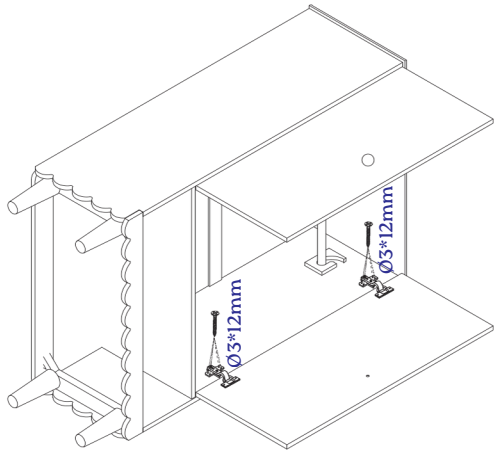

	8
---	---

28



	8
---	---

29

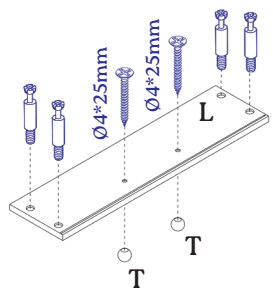

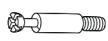
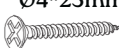
	2
	2

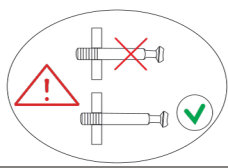

30

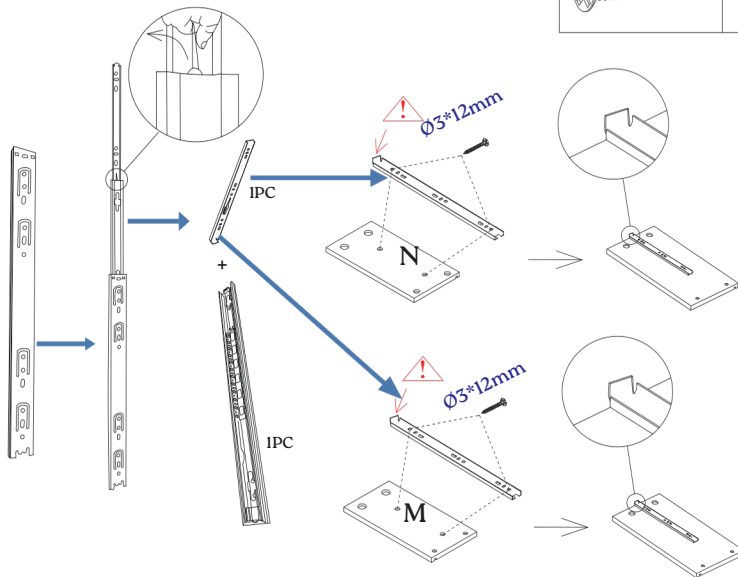

Ø3\*12mm



4

31

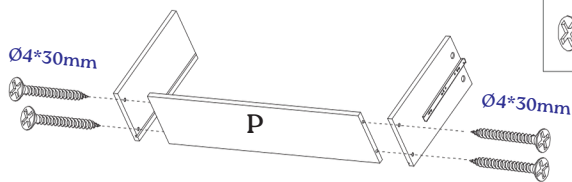

Ø4\*30mm



4

32

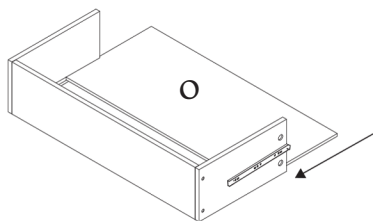

32

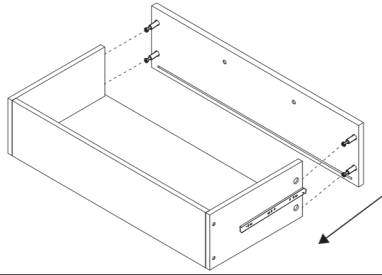

33

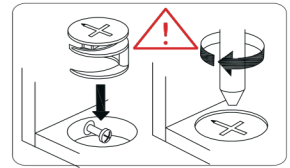
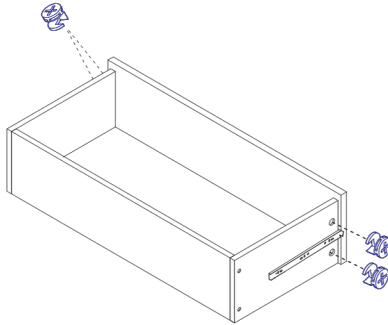

34

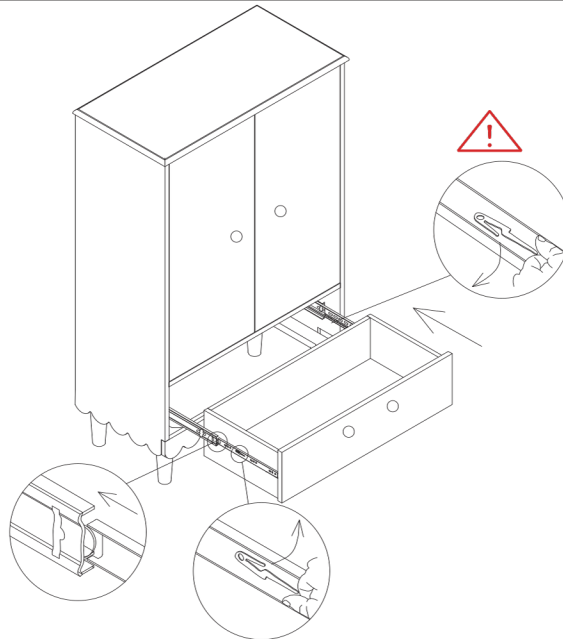

35

①

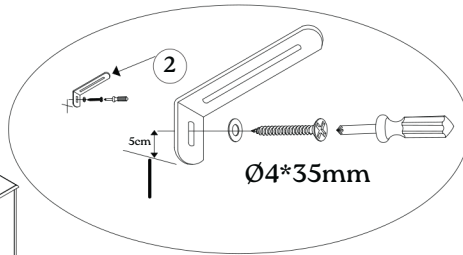
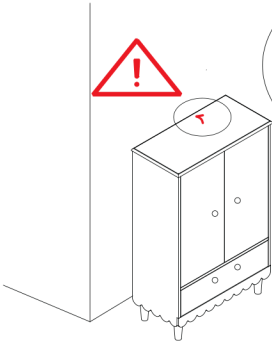
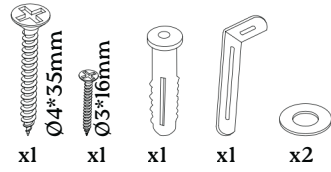
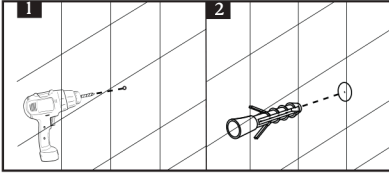

③

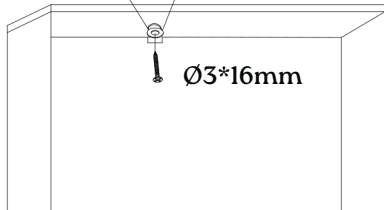
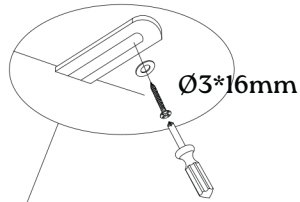



# Alice & Fox



Produced by:  
**Jollyroom AB**  
Sörredsvägen III SE-418 78  
Göteborg SWEDEN  
Contact: +46313100000  
[www.jollyroom.com/contact](http://www.jollyroom.com/contact)



Producerad av:  
**Jollyroom AB**  
Sörredsvägen III SE-418 78  
Göteborg SWEDEN  
Kontakt: +46313100000  
[www.jollyroom.com/contact](http://www.jollyroom.com/contact)



Produsert av:  
**Jollyroom AB**  
Sörredsvägen III SE-418 78  
Göteborg SWEDEN  
Kontakt: +4733509350  
[www.jollyroom.com/contact](http://www.jollyroom.com/contact)



Produceret af:  
**Jollyroom AB**  
Sörredsvägen III SE-418 78  
Göteborg SWEDEN  
Kontakt: 88448888  
[www.jollyroom.com/contact](http://www.jollyroom.com/contact)



Tuottanut:  
**Jollyroom AB**  
Sörredsvägen III SE-418 78  
Göteborg SWEDEN  
Asiakaspalvelu: 0942415555  
[www.jollyroom.com/contact](http://www.jollyroom.com/contact)



Produziert von:  
**Jollyroom AB**  
Sörredsvägen III SE-418 78  
Göteborg SWEDEN  
Kundenservice:  
+4904029997999  
[www.jollyroom.com/contact](http://www.jollyroom.com/contact)